

# RIG 10

## RIG

Gefco 200

Static Hook Load: 200,000 lb / 88,964 daN

Caterpillar C-18 (650HP) with Tier III Emission Controls

GVW: 44,300 kg, 20 m L X 3.21 m W X 4.37 m H

Pull Down Capacity: 13,608 kg (30,000 lb)

## MAST

Single Mast: 20 m / (65.6')

Maximum Working Clearance: 14.7 m (48.25') Range III

Gefco Two Speed Top Drive 18,000 ft / lb @ 100 rpm

9,000 ft / lb @ 180 rpm

Connection Torque: 36,000 ft / lb with Tongs

Fast Feed Rate Down: 67 m / min (219.8' ft / min)

Fast Feed Rate Up: 45.7 m / min (149.9' ft / min)

Top Drive Rated to 3,000 psi

## HYDRAULIC CATWALK

Hydraulic PLC Controlled Cat Walk from Floor

with Pipe Management System

Hydraulic Controlled Auxiliary Pipe Tubs

Range III Casing

V Door with Pipe Guard

GVW: 12,860 kg, 16.85 m L X 3.7 m W X 2.5 m H

## MUD PUMP

F-800 Triplex

Mission 50 HP 6 x 5 x 11 Pre-charge Pump

Stroke: 7.5" / 191 mm

Caterpillar C-27 Diesel (850 HP)

Liners Supplied: 6" / 152 mm

150 psi Compressor, Tool Board and Liner Cabinet

3,000 psi / 21,000 kPa Working Pressure with 4" Discharge

3" Oteco Pressure Relief Valve

GVW: 30,970 kg, 11.7 m L X 3.65 m W X 3.6 m H

## MUD TANKS

Mud System Total Volume 48 m<sup>3</sup>

Trip Tank Volume: 2 m<sup>3</sup>

2 x 30 HP Mission Pumps (4 x 3 x 13)

King Cobra Linear Motion Shale Shaker

Poor Boy De-gasser, Mixing Hopper, Mud Guns

2 - 5 HP Agitators

GVW: 27,790 kg, 15.35 m L X 3.75 m W X 3.6 m H

## WATER TANK / DOGHOUSE

Total Volume: 80 m<sup>3</sup>

Doghouse Inside Water Tank for Transport c/w

Hydraulic Lift System

2 Heaters, Pason, Lockers for Drillers, Tool Board, Knowledge Box

6 m Core Bench, 7.5 HP Water Circulating Pump, Pressure Washer

7.5 HP Water Pumps, Pressure Washer

GVW: 24,940 kg, 12.2 m L X 3.7 m W X 3.6 m H

## SUBSTRUCTURE

11' Floor Height, Hydraulic Ramp with 2 - 125,000 lb Cylinders

Hydraulic Power Pack to Operate Substructure & Pipe Tubs

B.O.P. Carrier for Infield Rig Moves

GVW: 38,000 kg, 16.53 m L X 3.61 m W X 4 m H

## WELL CONTROL

Class III 9" / 228.6 mm 3,000 psi / 20,800 kPa

3" Flare Line / 8" De-gasser

Control Technology 80 Gallon Accumulator

4 Station with PLC Remotes

2 - 2.0625" 5,000 psi Chokes

3" X 5,000 psi / 35,000 kPa Manifold c/w 3" 3,000 psi

Gut Manifold

## WINTERIZATION

Boiler Size: 100 HP Hurst

Water Storage: 13,000 L High Fire /

Low Fire Webster Burner

GVW: 15,690 kg, 7.9 m L x 3.75 m x W 2.74 m H

## TUBULARS

2,500 m 4" Range II raised 300 XT Hardband 3

on Box End Only

630 m 4.5" Core Pipe

Summer Loads: 8 (Excluding Pipe)

## COMBINATION BUILDING

Cummins Diesel 300 kW Powerplant

15,000 L Fuel Tank (TC44 Certified)

50 psi Air Compressor, Tool Board

Control Technology Accumulator

GVW: 25,430 kg, 12.7 m L X 3.2 m W X 3.6 m H

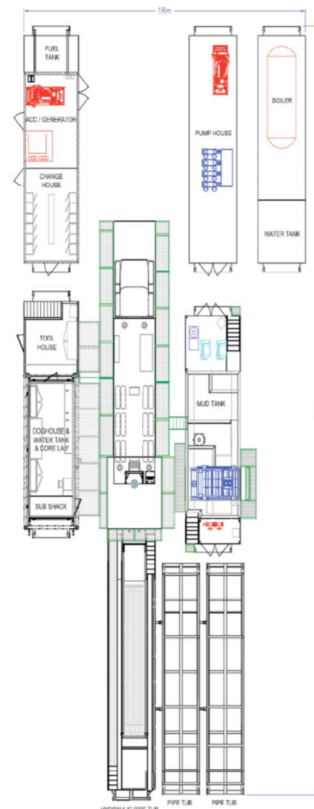

# RIG 10

