

RIG 17

RIG

Alco 450
Tandem Axle Trailer Mounted 16 Wheeler
Static Hook Load: 200,000 lb / 89,000 daN (8 line)
Caterpillar C-18 (700 HP)
Alco 450 Single Drum Draw Works with Cobalt Disc Assist (42-10)
Sand Line Core Retrieval Winch / Survey Winch
GVW: 62,000 kg 24.4 m (L) x 3.85 m (W) x 4.8 m (H)

MAST

Foremost 150T Topdrive, 25,000 ft / lb, 3 Speed, 200 rpm
Maximum
Connection Torque: 36,000 ft / lb with Tongs
Maximum Working Clearance: 15 m (49.2')
Topdrive rated to 5,000 psi

SUBSTRUCTURE

Trailer Mounted
3.35 - 4 m Drill Floor Height
Table Bushing Capacity 200,000 lb / 89,000 daN
Bushings Out 27.5" Opening
BOP Handling System for BOP's up to 13 5/8 Class II

HYDRAULIC CATWALK

Hydraulic Catwalk with Pipe Management System
Hydraulic Controlled Auxiliary Pipe Tubs
4 Leveling Jacks
BHA Storage in Catwalk
V Door with Pipe Guard
GVW: 14,820 kg 17.4 m (L) x 3.7 m (W) x 3.2 m (H)

MUD PUMP

F-1000 Triplex
Mission 50 HP Precharge Pump
Stroke: 7.5" 191mm
Caterpillar C27 850 HP Diesel Engine
150 psi Air Compressor with Tool Board
3,000 psi / 21,000 kPa Working Pressure with 4" Discharge
Oteco 3" Pressure Relief Valve
GVW: 30,970 kg 11.7 m (L) x 3.7 m (W) x 3.6 m (H)

MUD TANK

Trip Tank Volume: 2.97 m³
Suction Tank Volume: 4.95 m³
Shaker Tank Volume: 9.43 m³
Total Volume: 50 m³
Mix Pump and Hopper
King Cobra Shaker
3 x 2 Manifold 3,000 psi
Pressure Washer
24,490 kg
15.2 m (L) x 3.9 m (W) x 3.2 m (H)

COMBINATION BUILDING

Cummins Generator Engine 6CTA8 175 kW Newage Generator
(480 V / 208 V)
80 Gallon 4 Station Accumulator
10,000 L Fuel Tank (TC-44 certified)
GVW: 25,040 kg 13.8 m (L) x 3.1 m (W) x 3.2 m (H)

WATER TANK / DOGHOUSE

Total Volume: 60 m³
Doghouse Inside Water Tank for Transport
c/w Self Raising System
7.5 HP Water Circulating Pumps c/w Pressure Washer
GVW: 30,000 kg, 12.2 m (L) x 3.7 m (W) x 3.8 m (H)

RIG MANAGER'S SHACK

GVW: 15,450 kg 14.8 m (L) x 3.9 m (W) x 4.2 m (H)

WELL CONTROL

9" BOP's x 21,000 kPa (3,000 psi)
3" Flare Line 8" De-gasser
3" x 3,000 psi Manifold c/w 3" 3,000 psi Gut Manifold

WINTERIZATION

Saskatoon Boiler (60 HP)
Fuel Tank Volume: 6,500 litres
Water Tank Volume: 14.5 m³
GVW: 9,550 kg 9.9 m (L) x 3.2 m (W) x 3.2 m (H)

TUBULARS

2500 m x 4" Drill Pipe
4 W DC x 4
6 1/2 DC x 4
Summer Loads: 8 (Excluding Pipe)

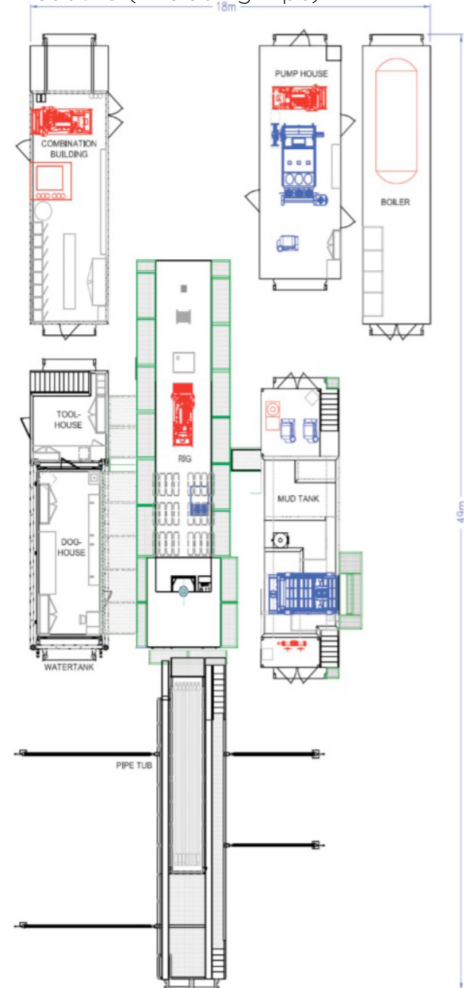

RIG 17

